

CROSBY CANYON

OHV



OFF THE BEATEN PATH:	YES
BEST SEASON:	YEAR ROUND
VEHICLE:	4WD/ATV
CAMPING:	PRIMITIVE CAMPING
AVERAGE TIME:	FULL DAY
DIFFICULTY:	MODERATE
ELEVATION:	3717 FEET
GETTING THERE:	

Take a back-road adventure and spend the day playing, jeeping, swimming, fishing, boating, camping or riding one of many ATV trails near Crosby Canyon and Lake Powell's Warm Creek Bay. The drive through Crosby Canyon is a beautiful gorge, with narrow twists and turns. There is evidence that it was underwater long ago. When you reach the end of Crosby Canyon the cliffs open up to a spectacular view of Lake Powell. There are many small beaches and peninsulas for camping, swimming and the fishing is the best or just sit back relax and enjoy the views. It is not recommended to make this drive when roads are wet, as it can be impassable.

- From Kanab, take HWY 89 east 57 miles to Big Water.
- Turn left just past mile post 7.
- Look for the Ethan Allen Road off of HWY 89 and turn north.
- Take road #300, the Smoky Mountain Road for 9.3 miles.
- Watch for the Crosby Canyon sign road #231 and turn right.
- At 3.95 miles to the Warm Creek Canyon overlook.
- Enjoy your day at the lake.

DISCLAIMER

"This map and directions are intended for general reference use only. Always check local road and weather conditions. Stay on designated roads. Dirt roads are impassable when wet. Please respect Private Property. Be prepared for a wilderness experience: Always bring extra water, food, sunscreen, and supplies. Cell phone service is non-existent in most areas! Do not remove artifacts or deface the 'rock art'. Leave no trace of your visit so others may enjoy."

Kanab Visitor's Center: 78 S 100 E PHONE: 435.644.5033



CROSBY CANYON

ATV/4WD

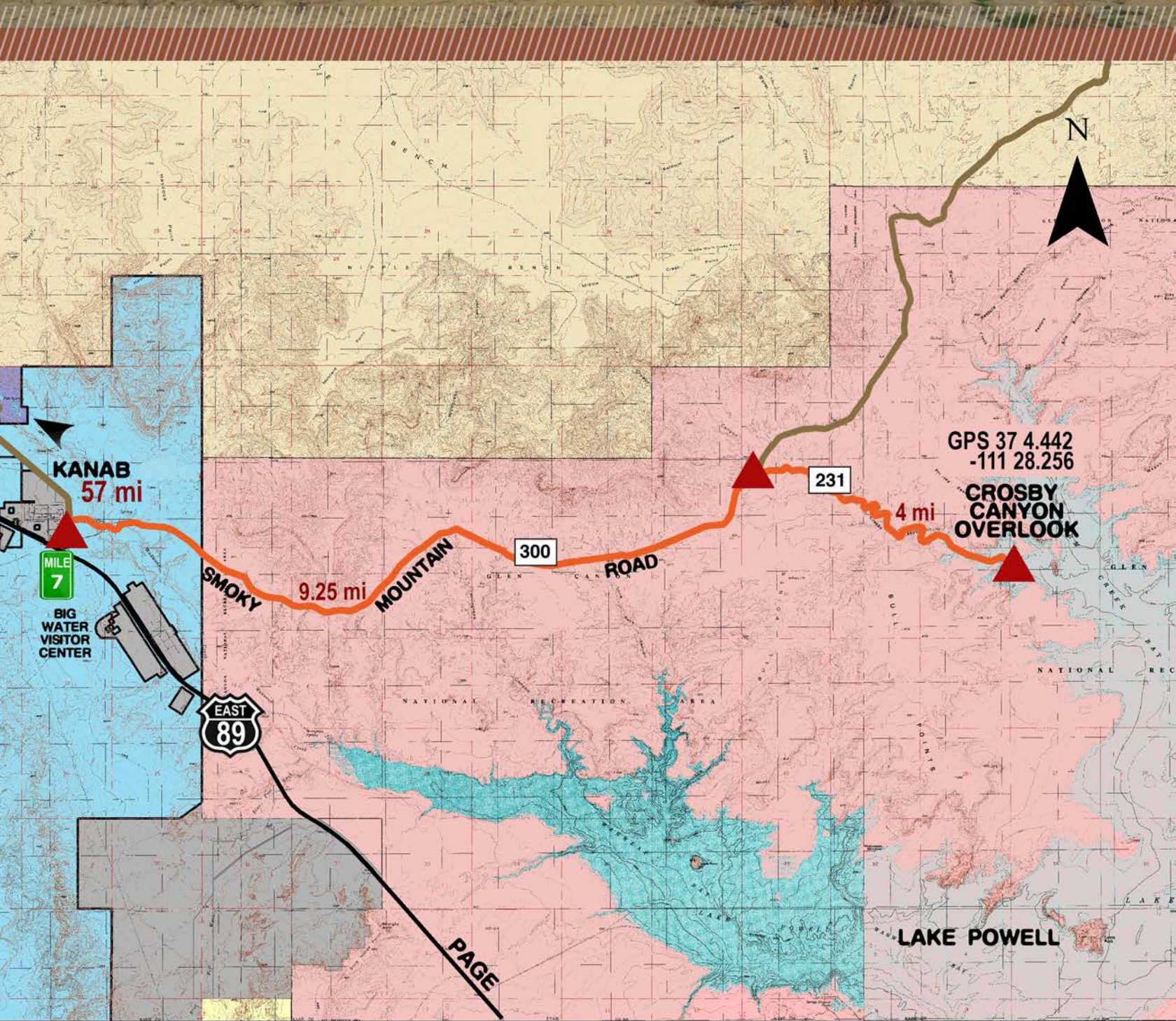

ADVENTURE MAP



tread lightly!
treadlightly.org

LIFE
UTAH
ELEVATED



KANAB
MAGICALLY UNSPOILED